

NOTES:

1. APPLICABLE STANDARDS/SPECIFICATIONS:
 - A. DOD-STD-00100D (AR)
 - B. ASME Y14.5M - 1994
2. UNLESS OTHERWISE SPECIFIED, BREAK EDGES .015 MAX, FILLET R .015 MAX.
3. ALL DIMENSIONS APPLY AFTER PLATING.
4. MATERIAL: MAKE FROM 10-0087 OR 10-0088 OR 10-0089

REVISIONS			
SYM	DESCRIPTION	DATE	APPROVAL

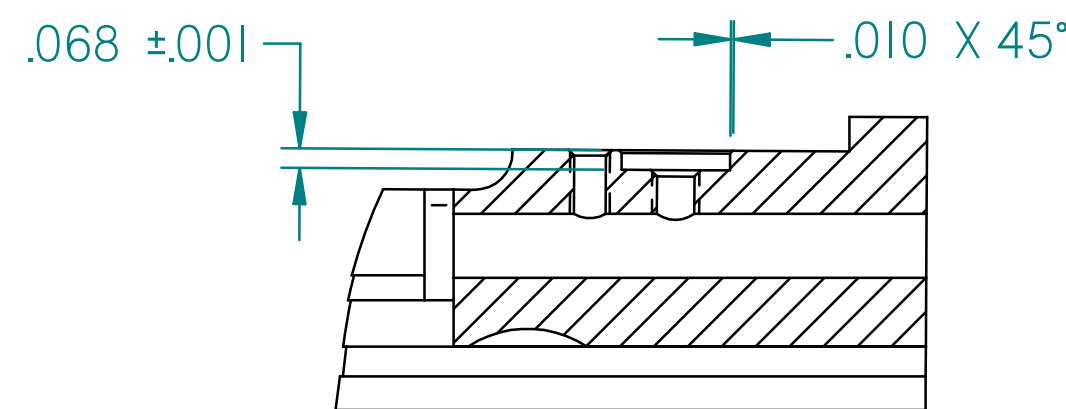
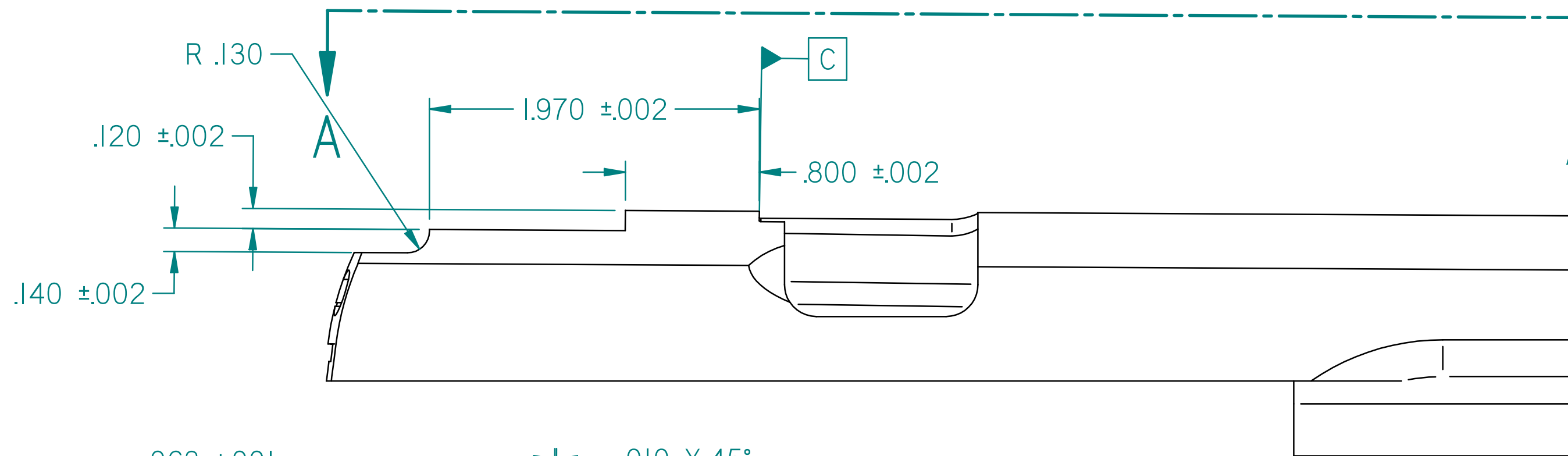
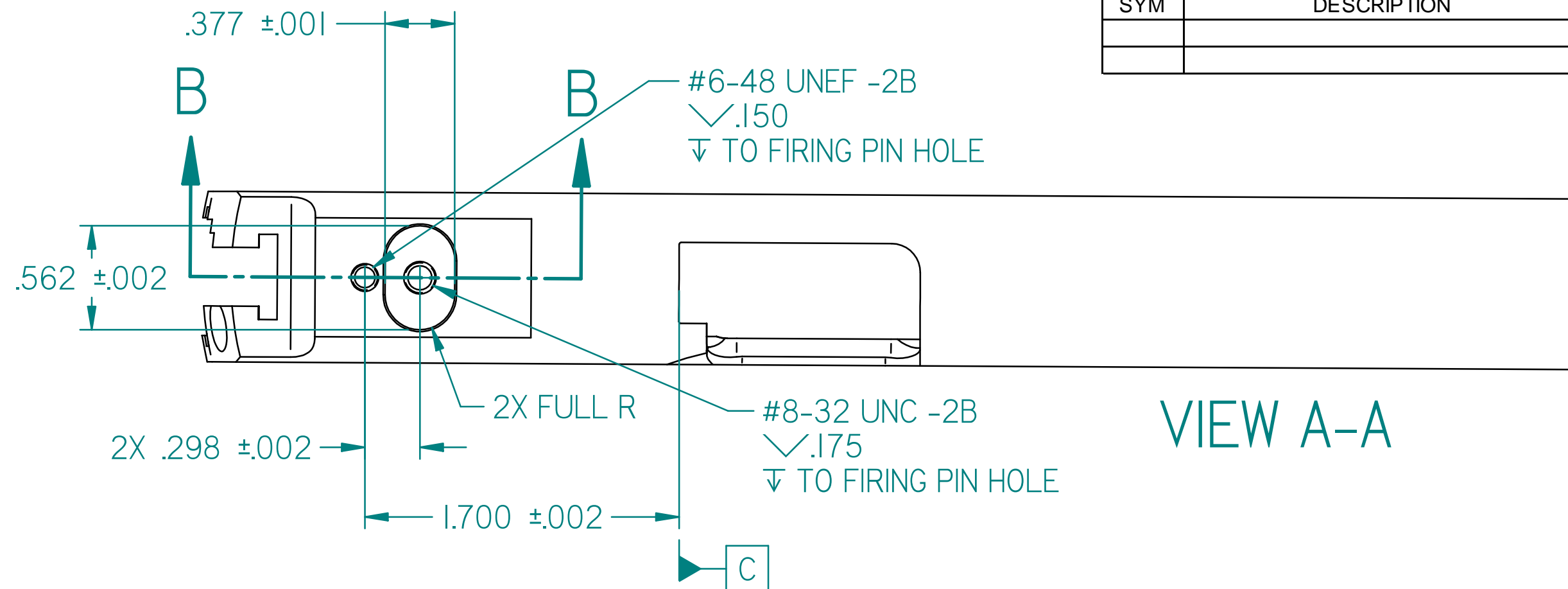

SECTION B-B

PART NO. 11-0180

NOTICE: PROPRIETARY DATA

THIS DOCUMENT CONTAINS TRADE SECRETS AND UNPUBLISHED PROPRIETARY INFORMATION WHICH IS THE PROPERTY OF WILSON'S GUN SHOP, INC. DBA WILSON COMBAT. BY ACCEPTING POSSESSION OF THIS DOCUMENT, THE RECIPIENT AGREES TO KEEP THIS DOCUMENT AND THE INFORMATION THEREIN CONFIDENTIAL AND TO NOT DISCLOSE SUCH INFORMATION EXCEPT AS SPECIFICALLY AUTHORIZED IN WRITING FROM WILSON COMBAT AND TO KEEP THE DOCUMENTS SAFE AND TO RETURN THEM TO WILSON COMBAT UPON DEMAND.

MECHANICAL PROPERTIES		DO NOT SCALE DRAWING		ORIGINAL DATE OF DRAWING		WILSON COMBAT	
YP		UNLESS OTHERWISE SPECIFIED DIMENSIONS ARE IN INCHES		09-26-11		2234 CR 719, BERRYVILLE, AR 72616	
YS		TOLERANCE ON: ANGLES ± .5°		DRAFTSMAN	CHECKER	428 SIGHT CUT	
EL2		DECIMALS: .XX ±.01		IW			
RA		.XXX ±.005		ENGR	ENGR		
BH		THIRD ANGLE PROJECTION		ENGR	ENGR	SIZE	CAGE CODE
RH						C	OWSZ3
NEXT ASSY	USED ON			DRAWING NO.		11-0180	
APPLICATION				SCALE 10/1		TASK	SHEET 1 OF 1